

Functional design of construction together with highly professional technical features. Top desk (part underneath the plates or burners) is made of high quality steel AISI 304. 70 mm space gap between the wall and supporting legs provides an extra room for installation fittings.



- Possibility of economic transport due to the opportunities of supplying the option “to assemble” feet are included.
- 1 mm top desk made from AISI 304
- Internal thermostatic protection inside each plate
- Plate dimension 300 x 300 mm
- 6 level output regulation
- Drawer for dirt placed under hobs



SPL 70/50 E



SPL 70/80 E

| Index | Model | mm | kg | V / Hz | kW | Plates kW / mm | °C Plates |
|-------------|-------------|-----------------|------|-------------|----|-------------------|--------------|
| 117 260 128 | SPL 70/50 E | 500 x 700 x 900 | 53,6 | 400 / 50-60 | 6 | 2 x 3 / 300 x 300 | 50-380 |
| 117 260 157 | SPL 70/80 E | 800 x 700 x 900 | 94,7 | 400 / 50-60 | 12 | 4 x 3 / 300 x 300 | 50-380 |

SPL 70/50 E

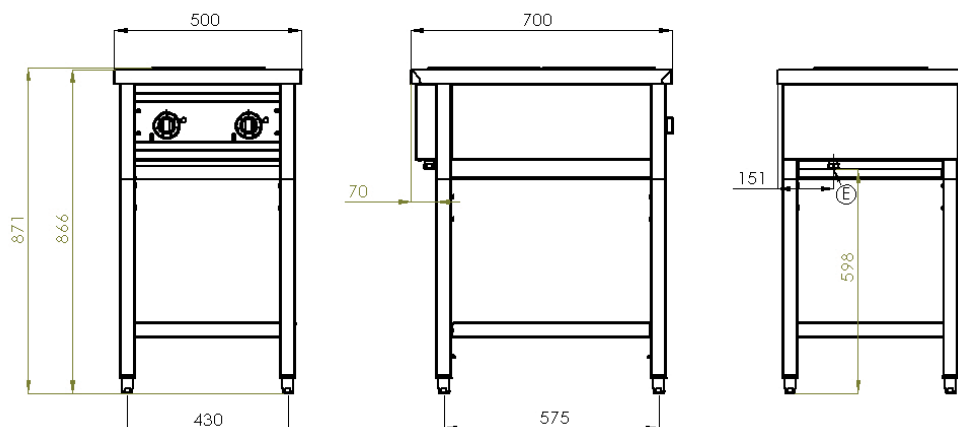

SPL 70/80 E

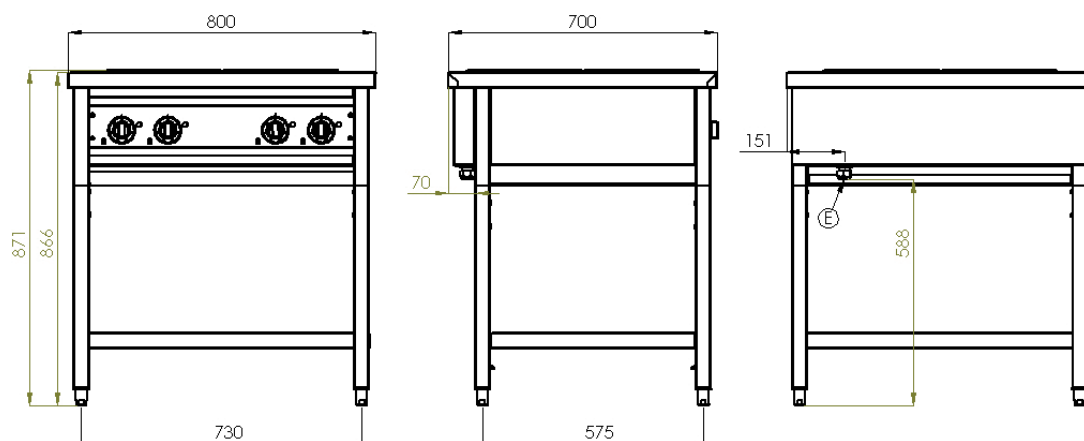

E – electric